

Langley Public Library

Historic Preservation Commission Pre-Design Meeting

October, 11 2022

MSRDesign



- 100 Years of the Langley Library
- How we got to today.
- Community Partnerships and Insights

Langley Library Historical Elements

- East Doorway and Entry
- Windows
- Half Hip Roof
- Dedication Plaque and Important Signs
- Fireplace

Historical Characteristics

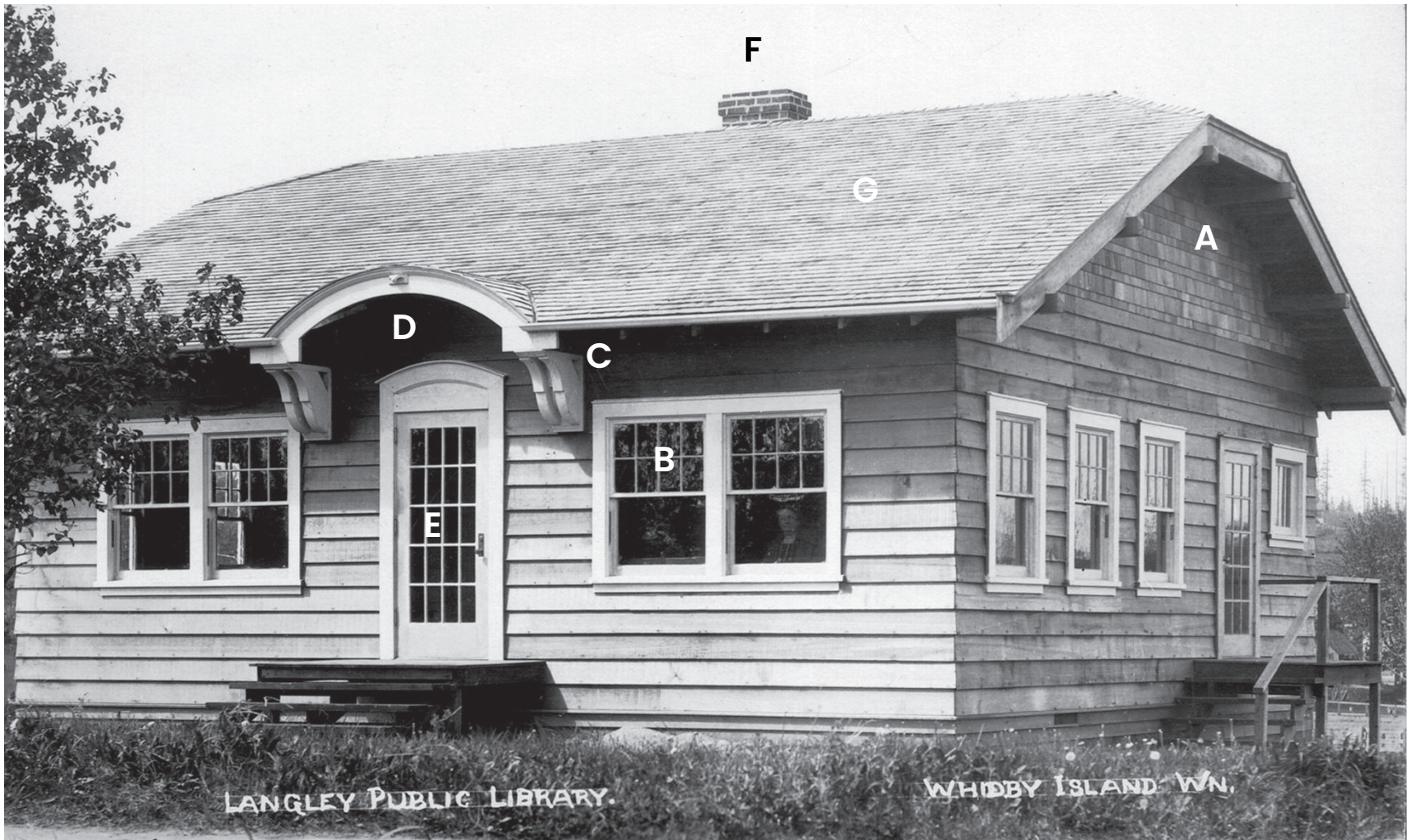

1923 Langley Public Library, North East corner. Courtesy Maureen Duryee

Historical Notes

- A Cedar shingle siding above clapboard siding on North and South walls
- B Double hung window muntin patterning (4 x 2 divided top-sash only)
- C Decorative roof supports
- D Arch entry
- E Glass entry door (4 x 5 divided lites)
- F Fireplace chimney
- G Half-hip composition shingle Roof



1953 Langley Public Library, view from North west. Courtesy Langley Public Library

Historical Notes

- A Non-original entry steps
- B Entryway, modified landscaping



ca. 1980 Langley Public Library, view from East. courtesy Langley City Hall

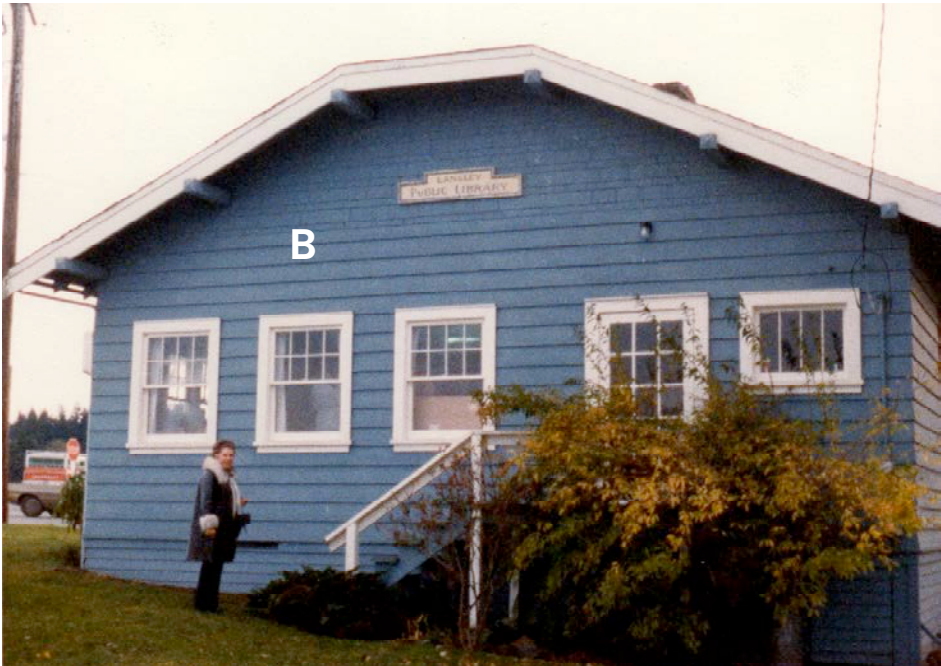

ca. 1980 Langley Public Library, view from North. Courtesy Langley Public Library

Historical Notes

- A Historic Plaque at right of door
- B Blue Color
- C Original Library Sign (missing)
- D Historical Commission plaque



2009 Langley Public Library sign, view of South. Courtesy R. Waterman



2022 Langley Public Library sign, view of South East Corner.

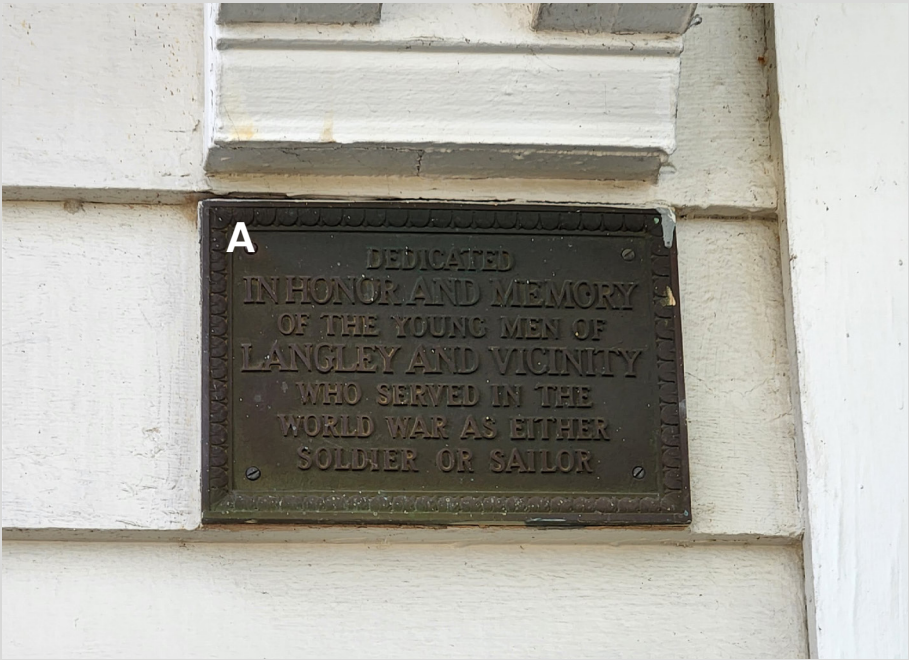

2022 Dedication plaque at right of door

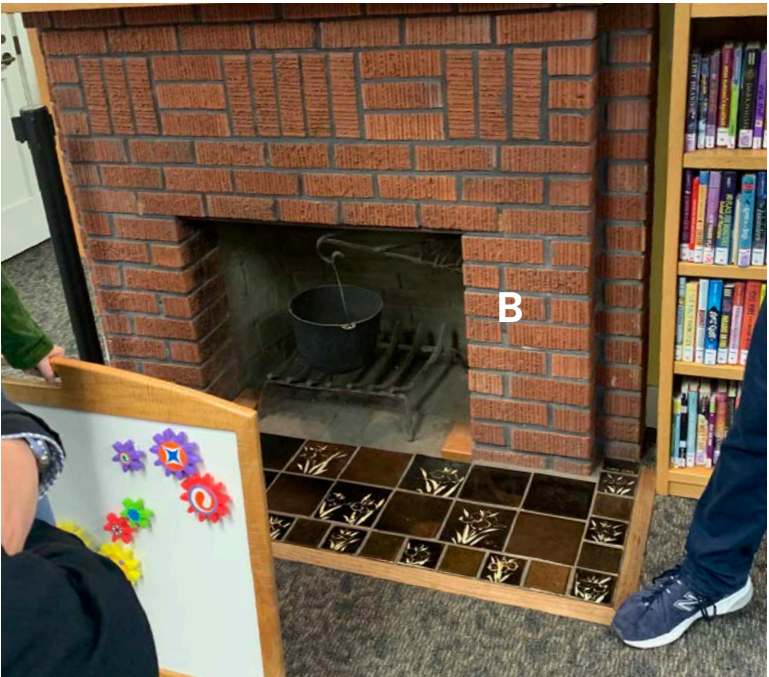
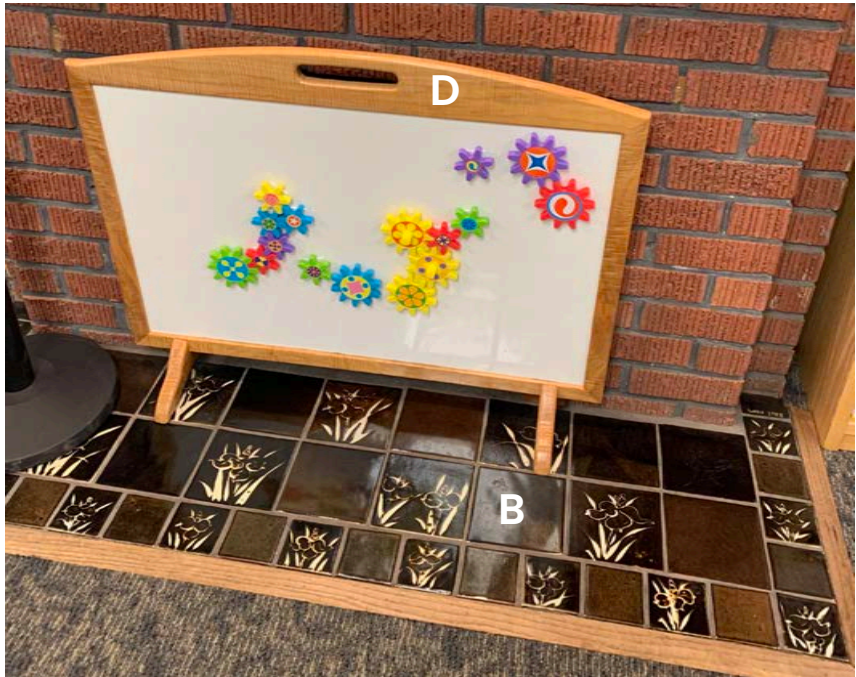

Historical Notes

- A Back of fireplace is covered with gypsum wall and used as mechanical plenum space
- B There is a record of the original fireplace at the current location. However, the existing fireplace and hearth were rebuilt in 1980.
- C Top of fireplace is also covered with gypsum wall and condition of fireplace behind the gypsum wall is unknown.
- D Firebox opening is currently covered due to safety concern



Historical Notes

- A Original beams and purlins with wood board ceiling
- B 2 x 4 troffer florescent light fixtures mounted under beams
- C East entry panel door (doesn't match to the original door in 1923)

Proposed Design

Review Items

- A Half-hip Roof
- B Energy efficient windows to match existing windows
- C Arch entry & decorative roof supports, remain
- D New glass entry door (4 x 5 divided lites)
- E Chimney remains and shingle roof
- F Railing & Ramp
- G Outdoor space
- H Outdoor space and Library sign with wooden bench top
- I Historical plaques
- J Provide library sign plaque to match to the library sign shown in 2009 photo
- K Existing tree to remain, existing power pole to remain, preserve native planting from Main Street Association, exploring solution for safety.



Rendering Langley Public Library, view from South East.



Rendering Langley Public Library, view of Entry

Proposed Design Notes

- A Arch entry & decorative roof supports, remain as is.
- B New glass entry door (4 x 5 divided lites) to match original entry door
- C Existing Plaque to remain
- D Existing Historical Commission Sign to remain
- E Existing windows to be replaced with energy efficient windows to match existing windows in appearance



Proposed Design Notes

- A Fireplace to be visible through glass for children's safety - indication of presence of fireplace.
- B Gypboard wall to be added in front of existing fireplace - arrangement of original space is maintained.
- C AV display will be mounted on gypsum furred wall - functional requirement to accommodate children's program.
- D Existing gypsum wall to remain

Rendering Langley Public Library, view of Interior fireplace and display



Proposed Design Notes

- A Existing purlins and beams with wood
- B Linear LED light fixtures (1" wide) under wood beams to preserve original ceiling aesthetic

Rendering Langley Public Library, view of Interior fireplace and display

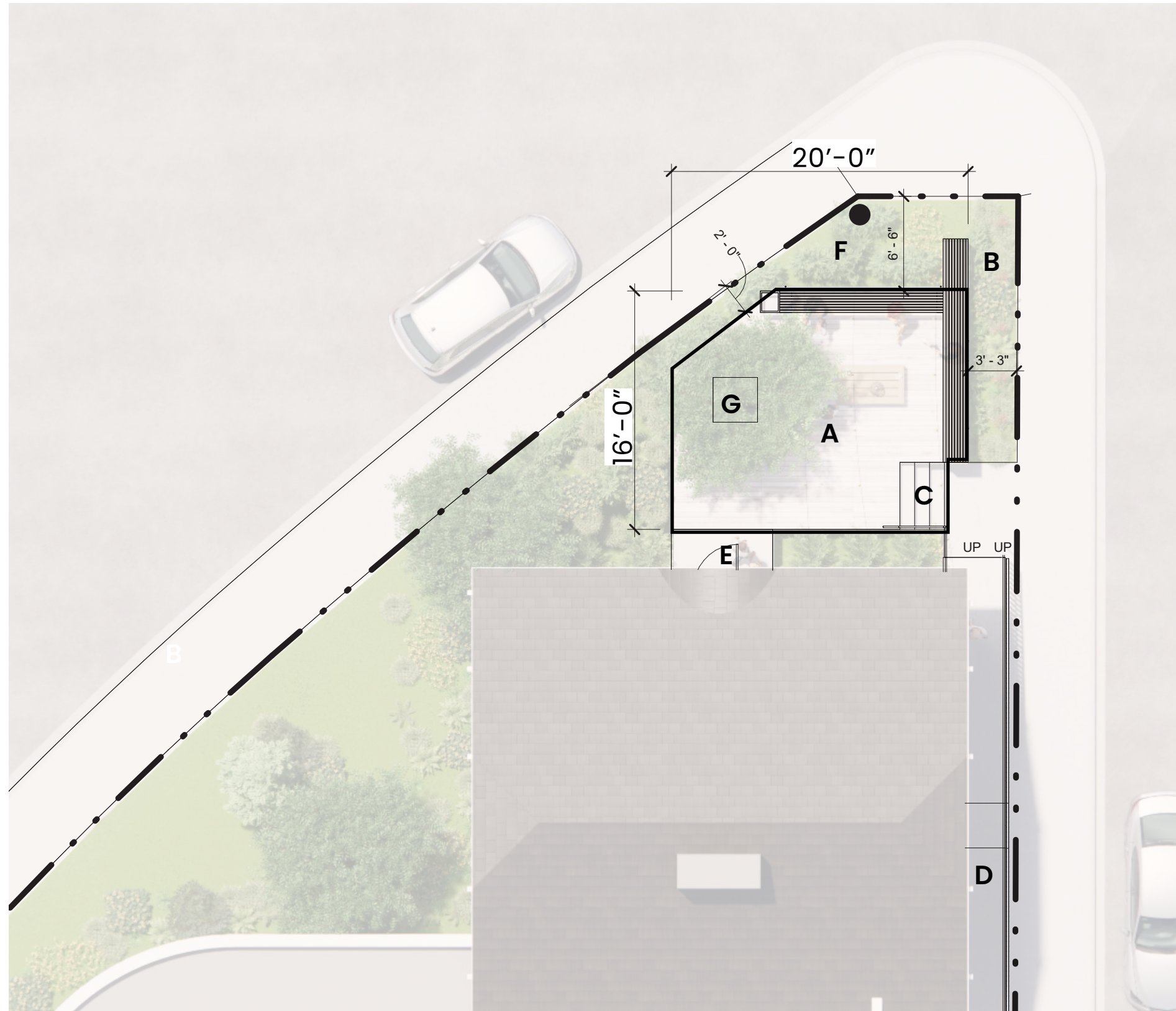

Top View Rendering Langley Public Library, diagram of Outdoor space

Proposed Design Notes

- A Outdoor space, approximately 16'x20' or ~300 sf*
- B Library Sign
- C Concrete Steps
- D Ramp & New Railing
- E Existing Stoop
- F Existing Power Pole
- G Existing tree to remain

*Existing drought-tolerant plantings disturbed by new outdoor space to be re-located on-site.



Photo of existing outdoor area

Proposed Design Notes

- A Existing drought-tolerant plantings disturbed by new patio deck to be relocated on site.
- B Existing tree to remain



Photo of existing outdoor area

Notes

Approximate location of deck shown with dashed line